

**PORTRISA**  
SECURITY AND FIRE DOORS

SECURITY  
**DOORS**





# LUXDOOR

## *PIVOT DOOR*

Luxdoor is a pivot system door, with an outstanding appearance, developed to meet even the boldest architecture project. A feat of modern design, it's an icon of innovation, character and refined taste. This door is suited to big wall openings, matching the facade of your household exquisitely.

It has a vertical pivot system which is adjustable in 3D. The door is made of an electro zinc steel structure combined with an outer steel plate. It's reinforced by 5 vertical omegas, combined together to form a solid whole. The frame and the leaf edges are made out of brushed stainless steel.

LUXDOOR is equipped with either Euro or Matrix or Hi-tech lock.

To ensure a high level of security, the door is strengthened with 13 locking points, 4 of which are located on the pivot side and the remaining 9 on the lock side.

It has automatic drop down cills installed, both on the bottom and on the top of the door leaf, blocking the entrance of dust, light, water and air draughts.



# LUXDOOR

PIVOT DOOR

## ELEGANCE

Develop every important detail in your home, our LUXDOOR model comes conquer with the refinement of its coatings in fine woods, high gloss lacquer, and stainless steel or stone finishes Swarovski.



## TECHNOLOGY

Access the convenience of opening your door through fingerprint, digicode, or even the from an electronic interface.

You can also use your Smartphone to find out who is inside your house or who tried open your door.



## QUALITY

At the forefront of cutting edge technology, LUXDOOR model can be produced in a single leaf up to 2 meters wide by 3 meters height, in a robotic and automated process with high quality materials. Developed by our engineering department every detail has been thought to the smallest detail.

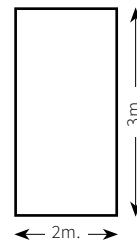

## SAFETY

In addition to its elegance and robustness, our doors integrate various protection systems and prevention against possible intrusion attempts, managing to go up to an armored protection level when safety is a priority.





### *THE SECURITY DOOR START AND MAX*

Portrisa's high Security doors have an electro zinc plated steel body, with double steel sheet on the outside, also with vertical omegas, making a solid constructed structure.

To ensure more and better security, the doors structure is strengthened even more on the areas surrounding the lock, hinges and bolts. Adjustable hinges made of steel and automatic mobile sill with adjustment screw to prevent air, light and dust penetration. Each one of our doors is supplied with a job key, that will be replaced by unique final key once the installation is completed.



# STRUCTURE

## COMPOSITION • Security Door

The door structure is made from electro zinc plated steel sheet of 1mm thickness forming vertical reinforcements (omegas) welded by points (RSW). The end product is a steel reinforced barrier with a total of 64mm thickness, designed to resist to the most advanced techniques of intrusion. Besides the quality, doors aesthetics and style are not compromised.

## SUB-FRAME

Built with 2mm electro zinc plated steel, it stays firmly fastened to the concrete wall with 8 powerful antisliding steel ties. This sub-frame is equipped with special fasteners allowing vertical and horizontal fitting adjustment, as well as easy assembly of the frame and door. This makes all the door installation extremely easy, the door can be applied to the sub-frame afterwards, this procedure is easy and free from hassle, it can save your door panels from getting damaged during house finishing job.



## START SERIES

The START door is built with an exterior layer of steel reinforced by 5 sheared internal omegas meant to bestow door's toughness.

### Start Series have 12 fastening points:

- 4 deadbolts +1 latch lock
- 1 top leading edge deadbolt
- 1 bottom leading edge deadbolt
- 4 hinge side bolts
- 1 safety catch



## MAX SERIES

The MAX door is built with an exterior layer of steel reinforced by 5 sheared internal omegas meant to bestow door's toughness.

### Max Series have 14 fastening points:

- 4 deadbolts +1 latch lock
- 2 top leading edge deadbolt
- 2 bottom leading edge deadbolt
- 4 hinge side bolts
- 1 safety catch



- 1 Frame and sub-frame
- 2 Vertical reinforcement omegas
- 3 Adjustable hinges
- 4 Leading edge bolts
- 5 Electro zinc steel structure
- 6 Great angular spyhole
- 7 Safety catch
- 8 High security lock
- 9 Finishing panel



# MODELS

## EURO

The high SECURITY PORTRISA door EURO model comes standard with a smooth turning european cylinder system lock, armoured with steel plate, the cylinder is shielded by a protection manganese steel defender system. The lock comes along with the keys, which are small and very easy to handle. You can have multiple cylinders with only 1 master key. The door is provided with temporary key while the installation is taking place, this temporary key will be replaced by 5 fresh new ones afterwards.



>Keyhole defender made with hardened manganese steel

Euro-Profile Cylinder Lock

Employees keys [Optional]

## MATRIX

The high SECURITY PORTRISA door MATRIX model has an easy and quiet double bit lock with easy combination swap. The lock is armoured with steel plate. Temporary key for door installation is supplied, once the door is installed, 5 new keys are delivered.



>Easy key combination swap

Double Bit Lock





## HI-TECH EASY

Portrisa's High SECURITY door, model HI-TECH Easy is equipped with electronic motorized lock (automatic opening / closing). Maximum security is combined with convenience. This door is equipped with a cylinder system European profile - key points (in case of emergency we can use the mechanical key).

The lock is protected from the outside by a steel plate.

The door is provided with 3 electronic approach and 2 mechanical keys.

The door works autonomously up to 35000 cycles opening and using only 6 simple commercial batteries to replacement.

Optionally, a digicode system for opening with personal code up to 8 numbers, or a reader biometric for fingerprint opening up to 1000 users and where it already requires an electrical connection.

Finishes available:  
Chrome / Brass

Electronic keys



OPTION 1  
Digicode



OPTION 2  
Digital biometric reader



## HI-TECH SMART

Portrisa's High SECURITY door, model HI-TECH Smart is equipped with electronic motorized lock (automatic opening/closing). Maximum security is combined with convenience. This door is equipped with a cylinder system European profile - key points (in case of emergency we can use the mechanical key). The lock is protected from the outside by a steel plate.

Model HI-TECH Smart offers the opening convenience with card or digicode system already included as standard. The door is supplied with 2 keys electronic opening by approach and works autonomously up to 35000 opening cycles and using only 6 commercial batteries for simple replacement.

A biometric reader can be optionally included, working on a mixed battery and connection system electrical.



Serial - Digicode



Access - card



Available for ANDROID and IOS systems



## **TOPSYSTEM**

PORTRISA's TOPSYSTEM door maintains the entire structure and Euro door quality, combined with an excellent system automatic closing, completely analog and without any electronics. This door has a panic security system, and SLS system (automatic lock system) in break-in case.





## **PREMIUM**

The PORTRISA PREMIUM high security door is characterized for an aesthetic image cared for in the most detail, with cleaner lines, thanks to its hidden hinge, its Luxury and Quality appearance is accentuated.

The PREMIUM door maintains all the characteristics that distinguish our high security door and can be manufactured on most models of the Start and Max series, only with the exception of fixed doors.

Portrisa's hidden hinge allows the door to be adjusted in height. Works with a sphere system that allows greater smoothness throughout your operation.



Portrisa concealed hinge



# CROSSPLANE

## **CROSSPLANE**

Resistance, luxury, unique architecture and minimalism are the Slogan in the PORTRISA CROSSPLANE model.

The model maintains all the characteristics that distinguish the our high security door and can be manufactured in most models of the Start and Max series.

Faced from the outside, the CROSSPLANE model allows a unique view and finishes, achieving a disguise on the facade allowing the adjustment of the door in height and width.





## DOUBLE LEAF

High SECURITY Door with two leaves, can be manufactured with different locking system, this front door has a great visual impact to your front entrance, giving your house a beautiful, imposing and secure entrance, matching the style of your home.



Top bolt adjuster



Passive leaf  
unlocking system





## FIXO

Portrisa's High SECURITY door, FIXO model, can be manufactured with the types of lock (Euro, Hi-Tech or Matrix). The side fixtures and the upper flag are prepared to take a glass 12mm laminate being fixed by a metallic bite, it can also be in panels in replacement of glass.







## POWER

Portrisa's High SECURITY door model POWER, with characteristics of fire-breaks, contains rock wool inside high density and intumescent ribbon on the rim which gives it the fire-break feature. With the installation of this door it is possible to eliminate the fire door normally used on building levels, etc.

It is a certified model according to UNE EN 13501-2 + A1:2013.

Included accessories:

- Automatic adjustable windbreak;
- Opening limiter, fixed to the rim activated inside by a button;
- HOPPE design handles;
- Mobile handle inside;
- Fixed handle on the outside;
- Latch tuner (anti card);
- Firebreak - EI<sub>2</sub>30;
- Firebreak - EI<sub>2</sub>60.





# BLOCK HOTELL

## HOTELL

PORTRISA's HOTELL model door was specially designed for the hospitality sector and one of its main advantages is easy change the appearance in case of remodeling thanks to the decorative panel system.

The HOTELL door is made on the EI<sub>2</sub> 45 fire BLOCK model.

Inside it has high density rock wool and intumescent hoops with wooden finishes. The door can be machinated for the locks of major brands of access control systems in the hotel.



Mechanization of hotel lock





## ECODOOR

In order to provide a SECURITY door with the same quality and beauty for less demanding and more economical markets, PORTRISA decided to innovate and created the ECODOOR model.

The structure, finishes, lock and cylinder remain intact, and their differences stand out for the lack of windbreak, anti-perforation shield, opening limiter and safety locks safety.





## **PUSH**

The high security door, model PUSH from PORTRISA, opens to the outside and is provided with a high security lock activated by a panic bar. Equipped with lock European cylinder system protected by an anti-puncture safety shield. The lock is protected from the outside by a steel plate.

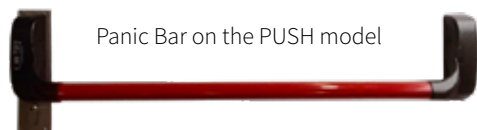

Panic Bar on the PUSH model





Ballistic panel in Kevlar

Ultra-resistant fiber, used by the forces of security and military in vests bulletproof. It's formed by multiple layers of fabric and has mechanical resistance 5x higher than steel.



Structure reinforced

In addition to the layer ballistics, the structure the door was still more strengthened and was increased number of stitches closing, for resist this kind of attacks.



**BALLISTIC**

The high-security door, MAGNUM and NATO Ballistic models PORTRISA, contain a bulletproof panel inside composed of a military grade aramid fiber (Kevlar). This one panel, which together with the reinforced structure, form a perfect ballistic armor for situations where there is a threat attack using firearms such as:

bank branches, exchange offices, pawnshops, buying and selling gold, refuge / panic rooms, etc.

The door has a casual appearance in order to surprise potential attackers.

Different levels of ballistic protection depending on requirements:

**BALLISTIC DOOR MAGNUM**

Tested and certified EN1522 levels FB4 (NIJ III-A) and FSG  
 This level includes the main pistols and also the shotgun:  
 9 mm Glock 19  
 .357 Desert Eagle  
 .44 Smith & Wesson  
 12 gauge Beretta

**NATO BALLISTIC DOOR**

Tested and certified EN1522 level FB6 (NIJ III)  
 This level encompasses the caliber of weapons war, 7.62 mm and 5.56 mm for shotgun assault:  
 AK47 Kalashnikov  
 AR15 / M16 / M80



MAGNUM FB4

# DOOR DETAILS LUXDOOR



SIDEBOLTS



DOOR LOCK



3D ADJUSTABLE PIVOT



# LUXDOOR ACCESSORIES

## POWDER COATED COLOURS

Can be flat or with groove effects



Grooves

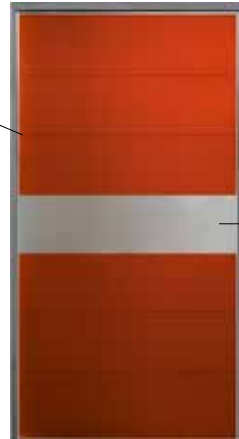

Stainless steel  
Brushed

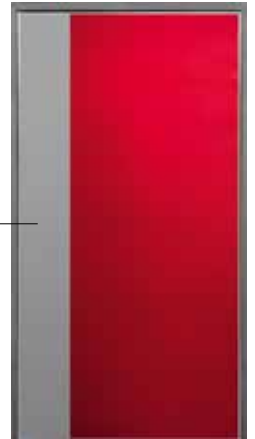

## POWDER COATED ALUMINIUM COLOURS

Can be flat with groove effects and stainless steel kick plate

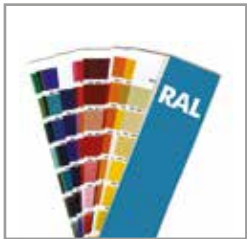

RAL lacquer of choice  
(option)



Internal handle



Swarovski internal handle  
(option)



Tubular Handle  
(stainless steel)



Square Door  
Handle  
(stainless steel)



Stainless steel handle with  
panel embedded (always equal  
to external door panel)

## DETAILS OF SAFETY

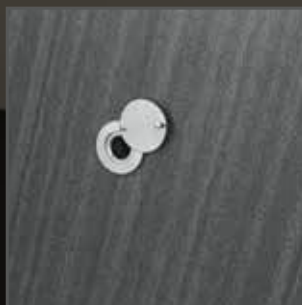

### SPY-HOLE

Available in two finishes, Chrome and Brass. The Spy-hole allows a 180° viewing angle.



### SAFETY LATCH

Integrated in the door, it allows a small opening of interaction with the outside through a convenient rotation button.



### DOOR LOCK

The high security lock with latch and four locks in 18mm diameter galvanized steel, protected by an anti-perforation plate



### ADJUSTABLE LATCH

The latch tuner includes an anti-theft system to prevent opening with ATM card or radiography.



### ANTI-DRILLING DEFENDER

(for European cylinder). Solid block in high manganese steel hardness, protects the cylinder against drilling attempts from the outside.





#### DOUBLE SEAL

Double rubber seal, one on the side of the sheet and the second on the side of the rim (in the photo). Guarantees some thermal and acoustic insulation to the door and frame and an airtight barrier to the passage of air, water and wind.



#### SECURITY HINGE

Allows height and width adjustment. Its axis rests on a system of spheres that allows a smooth operation of the door.



#### DEADBOLTS

4 15mm steel anti-breakout legs in diameter are placed on the same side of the hinges, preventing the door from breaking in with a crowbar, leaving it anchored in its housing.

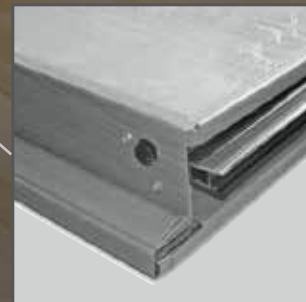

#### DROP-DOWN CILL

Applied in the lower area of the door, it guarantees sealing watertight against drafts, dust, air passages light and still allows some noise reduction.

# HARDWARE ACCESSORIES



Standard Brass furniture



Standard Chrome furniture



Square furniture (Option)



Tubular handle  
(Option)

Finishing:  
Stainless steel



Aluminium threshold and weather bar set  
(Option)  
Fixed aluminium cill.



Aluminium threshold  
(Option)  
Fixed on the floor, completely seals the water, air and wind passage.



Wood trim edge finish



Steel trim edge finish



Security window (Option)  
Opaque double laminated glass with air chamber, powder coated aluminium or stainless steel beadings, allows the passage of light without compromising the level of security.



Electric Latch

## Frames and edges



Black ± RAL 9005 (option) | Brown ± RAL 8017 | Grey ± RAL 9007 | White ± RAL 9003 | Stainless steel (option)

## Hinge covers



Grey | Beech | Oak | Golden | White

## HI-TECH ACCESSORIES



### DANALOCK

Controllable lock system by Bluetooth and through the Z-Wave protocol (European version). Allows closing / opening the door lock remotely, and assign an unlimited number of keys guests. You can define permanent or temporary accesses, alarms, and know exactly who used the lock, and when.



### DANAPAD

Give Access with Danapad Pin Codes. With its Bluetooth interface to the Danalock V3 smart lock, the Danapad V3 keypad extends secure, controlled access. You no longer have to bring a key or a phone when leaving home. With the Danapad V3, access has never been easier. Just create a pin code for each guest and the Danalock system takes care of the rest.

# SCHEMES INSTALLATION

## 01

### Assembly with Finishing in Stucco

- Stucco 1
- Wall 2
- Silicone joint  
(if necessary) 3
- Frame 4
- Sub-frame 5
- Steel Anchor 6

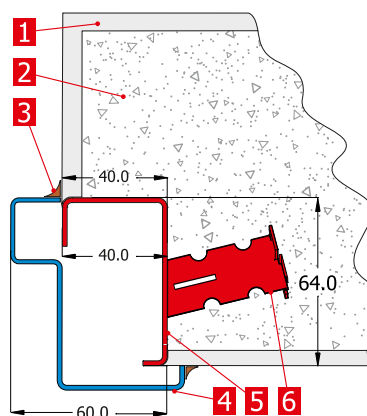

## 02

### Assembly with Finishing in Marble

- Marble Stone 1
- Wall 2
- Silicone joint  
(if necessary) 3
- Frame 4
- Sub-frame 5
- Steel Anchor 6

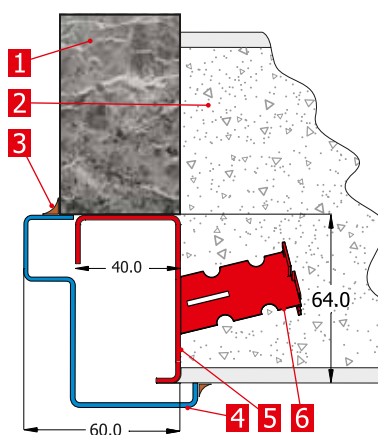

## 03

### Assembly with Finishing in Wood

- Wood 1
- Fill 2
- Wall 3
- Silicone joint  
(if required) 4
- Frame 5
- Sub-frame 6
- Steel Anchor 7

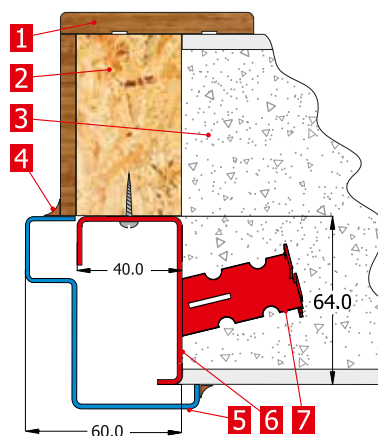

# STANDARD FRAME DRAWINGS

**TECHNICAL DRAWING • Standard Frame**

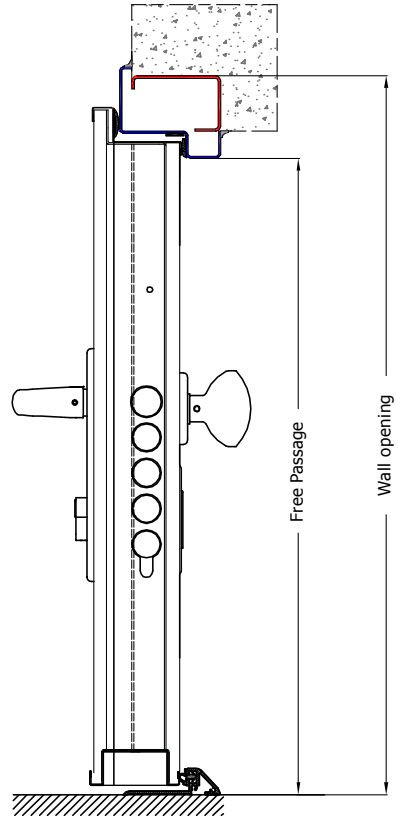
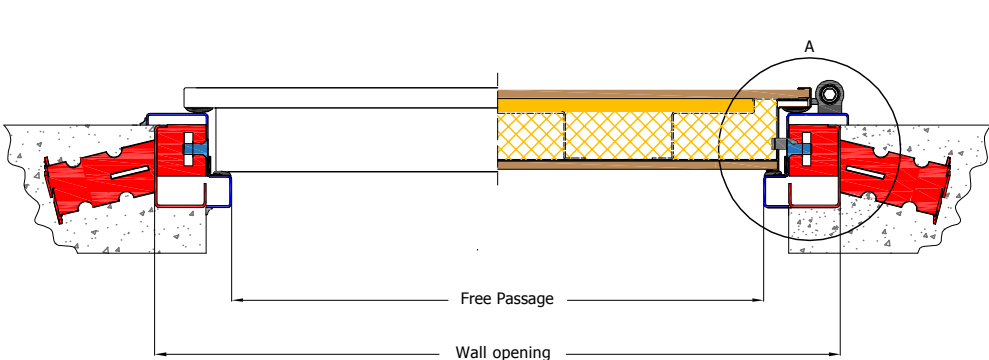

| Standard Dimensions           |                       |
|-------------------------------|-----------------------|
| Free Passage                  | Wall opening          |
| 800 x 2000/2040/2100          | 920 x 2060/2100/2160  |
| 850 x 2000/2040/2100          | 970 x 2060/2100/2160  |
| 900 x 2000/2040 /2100         | 1020 x 2060/2100/2160 |
| Maximum production dimensions |                       |
| Width = 1100                  | Height = 2400         |

- Plasterboard (BA13) (Power model option)
- Wooden finishing
- Thermal insulation filling (Power model option)

**TECHNICAL DRAWING • Standard Frame details**

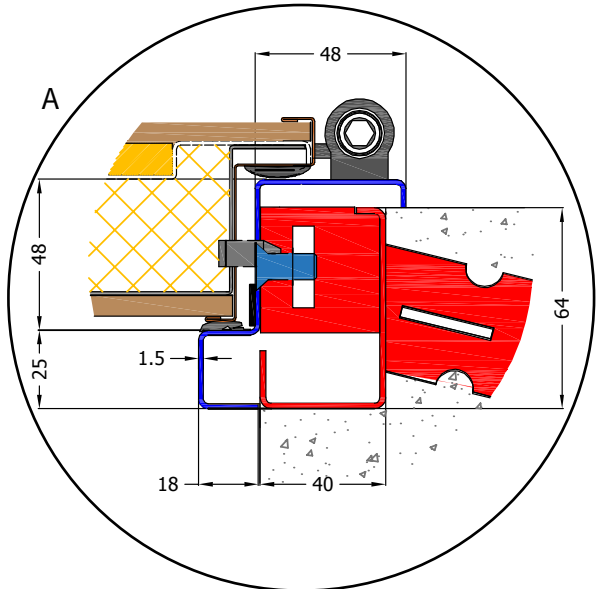

# BF FRAME DRAWING

Easy installation frame, it doesn't need the traditional sub-frame. This frame makes the installation work very easy due to the 11 adjustable screws fixed directly to the wall. The frame can be in Brown, White or bespoke RAL.

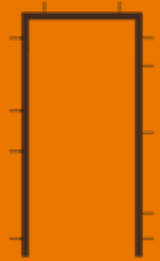

## TECHNICAL DETAILS • MIDDLE OF THE DOORWAY FRAME (BF)

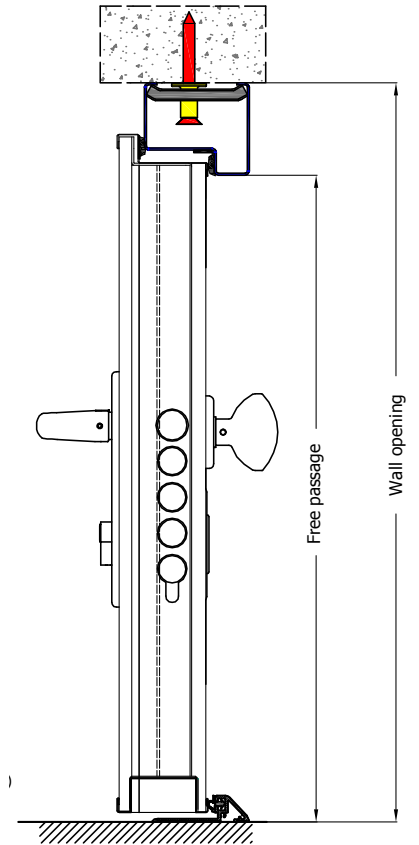
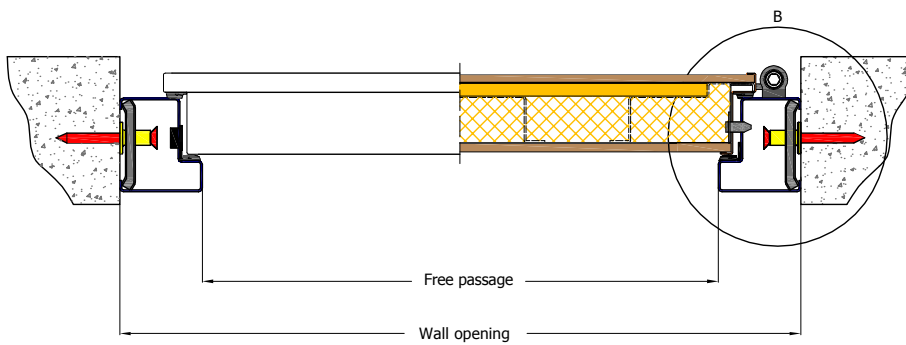

| Standard Dimensions           |                       |
|-------------------------------|-----------------------|
| Free passage                  | Wall opening          |
| 800 x 2000/2040/2100          | 920 x 2060/2100/2160  |
| 850 x 2000/2040/2100          | 970 x 2060/2100/2160  |
| 900 x 2000/2040 /2100         | 1020 x 2060/2100/2160 |
| Maximum production dimensions |                       |
| Width = 1100                  | Height = 2400         |

- Plasterboard (BA13) (Power model option)
- Wooden finishing
- Thermal insulation filling (Power model option)

## TECHNICAL DETAILS • Middle of the doorway fixation detail

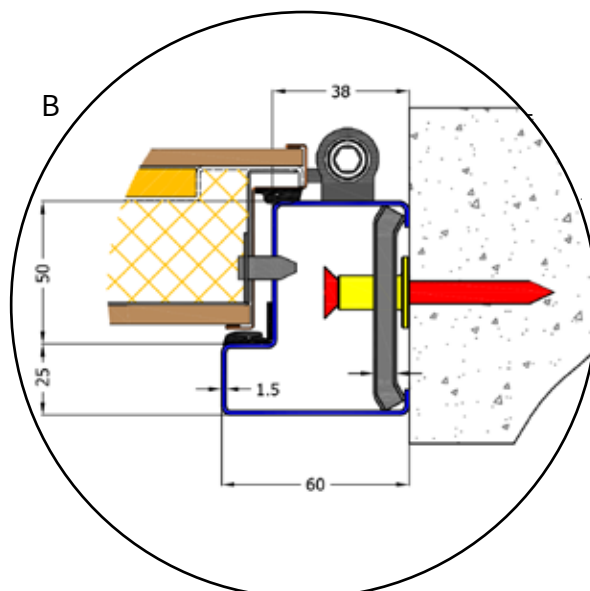

The Frame CB was born due to the need to mount security doors without Sub-frame.

# SCHEMES FRAME CB

## TECHNICAL SCHEME • FIXED RIM (CB)

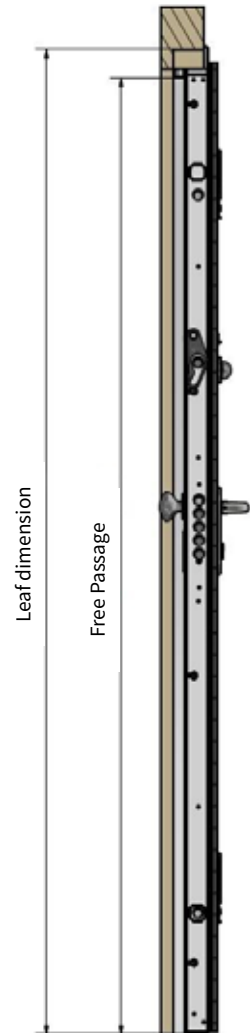
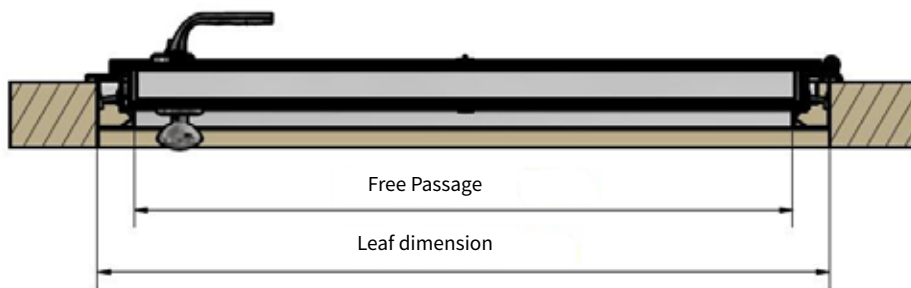

### FEATURES OF THE MODEL

- Simple assembly and fixing system.
- Replaces the Sub-frame installation.
- Option of fixing with 8 claws to anchor to the wall or 8 screws resistant wheels that pass the Frame fixing it to the structure.

## DATA SHEET • CB Fixed Frame Details

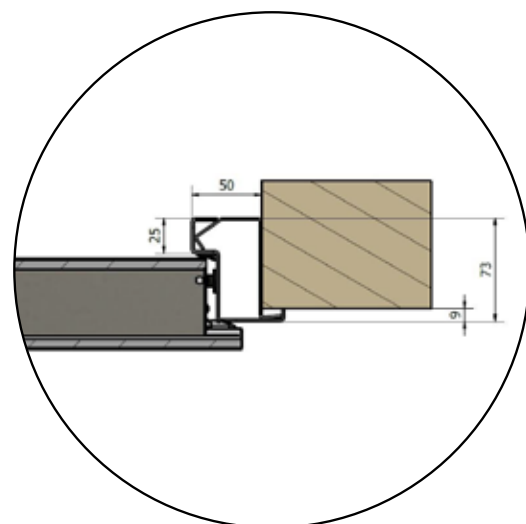
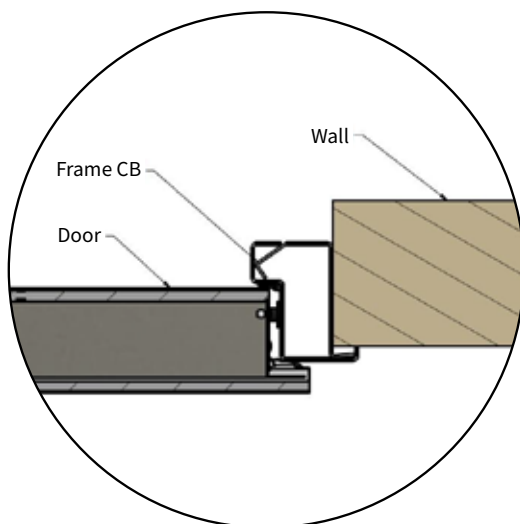

# RP FRAME DRAWING

Designed for a perfect and fast fit regardless of the existing frame configuration (wood or metal). Its smart adjustment allows the correction of all defects done on the initial installation.

## TECHNICAL DETAIL • RP Frame

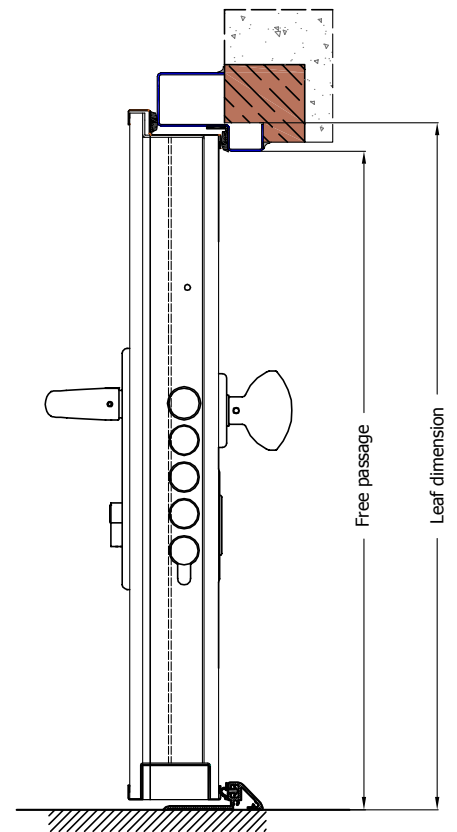
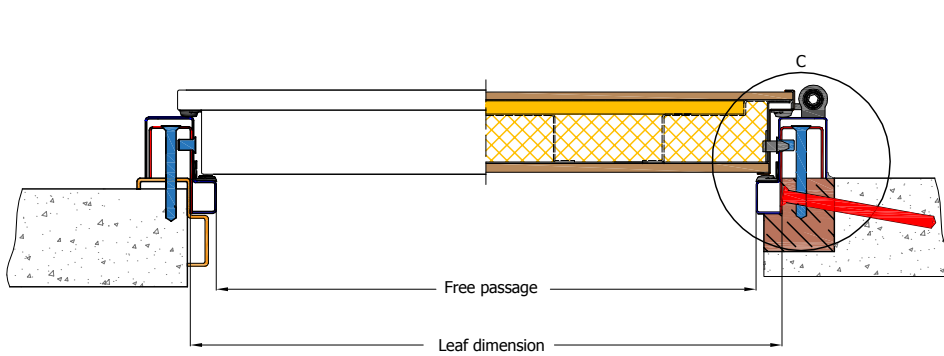

### Maximum standard dimensions

Free passage: 2100x900



Leaf dimension: 2123x945

### Extrapolation

Height: 1680mm / 2310mm

Width: 696mm / 957mm

Max. area: 22106,7 cm<sup>2</sup>

-  Plasterboard (BA13) (Power model option)
-  Wooden finishing
-  Thermal insulation filling (Power model option)

## TECHNICAL DETAIL • RP Frame detail

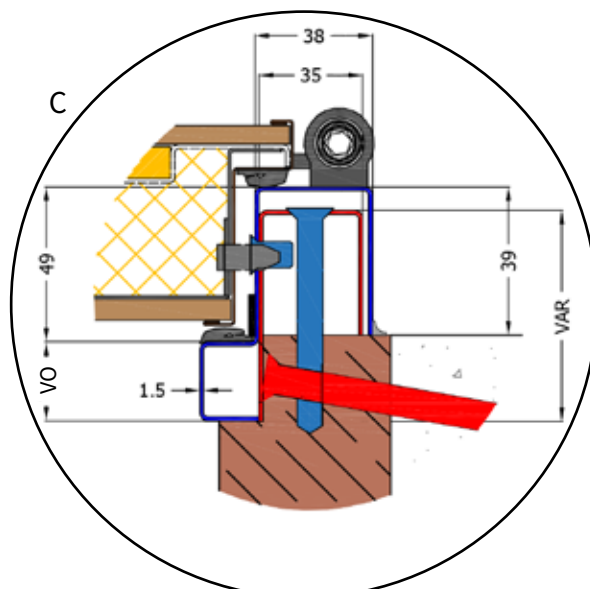



### 05

#### Installation with Side Window

- Sub-frame 1
- Frame 2
- Beading for glass fixation 3

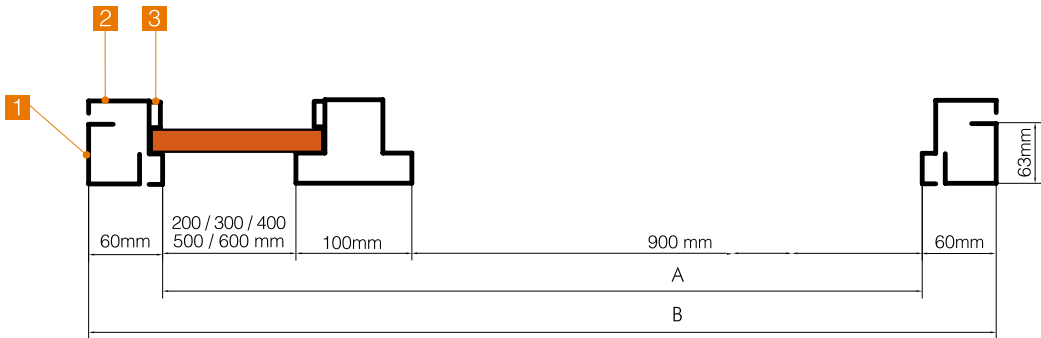

### 06

#### Installation with Double sidindow

- Sub-frame 1
- Frame 2
- Beading for glass fixation 3

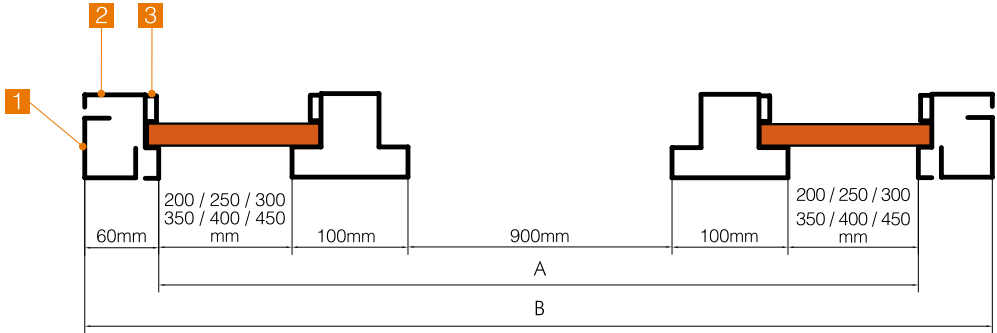

### 07

#### Installation with Fanlight

- Sub-frame 1
- Frame 2
- Glass fixation beading 3

- 1 A=2000 B=200 C=2360
- 2 A=2000 B=300 C=2460
- 3 A=2000 B=400 C=2560
- 4 A=2000 B=500 C=2660

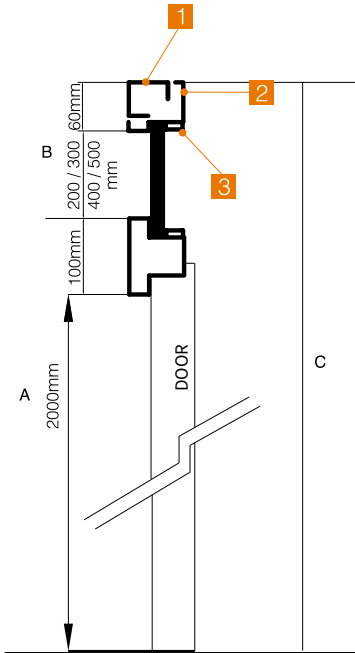

# TECHNICAL DRAWINGS

## Luxdoor Pivot Door

**TECHNICAL DRAWING • Example 2065x1200 (VO)**

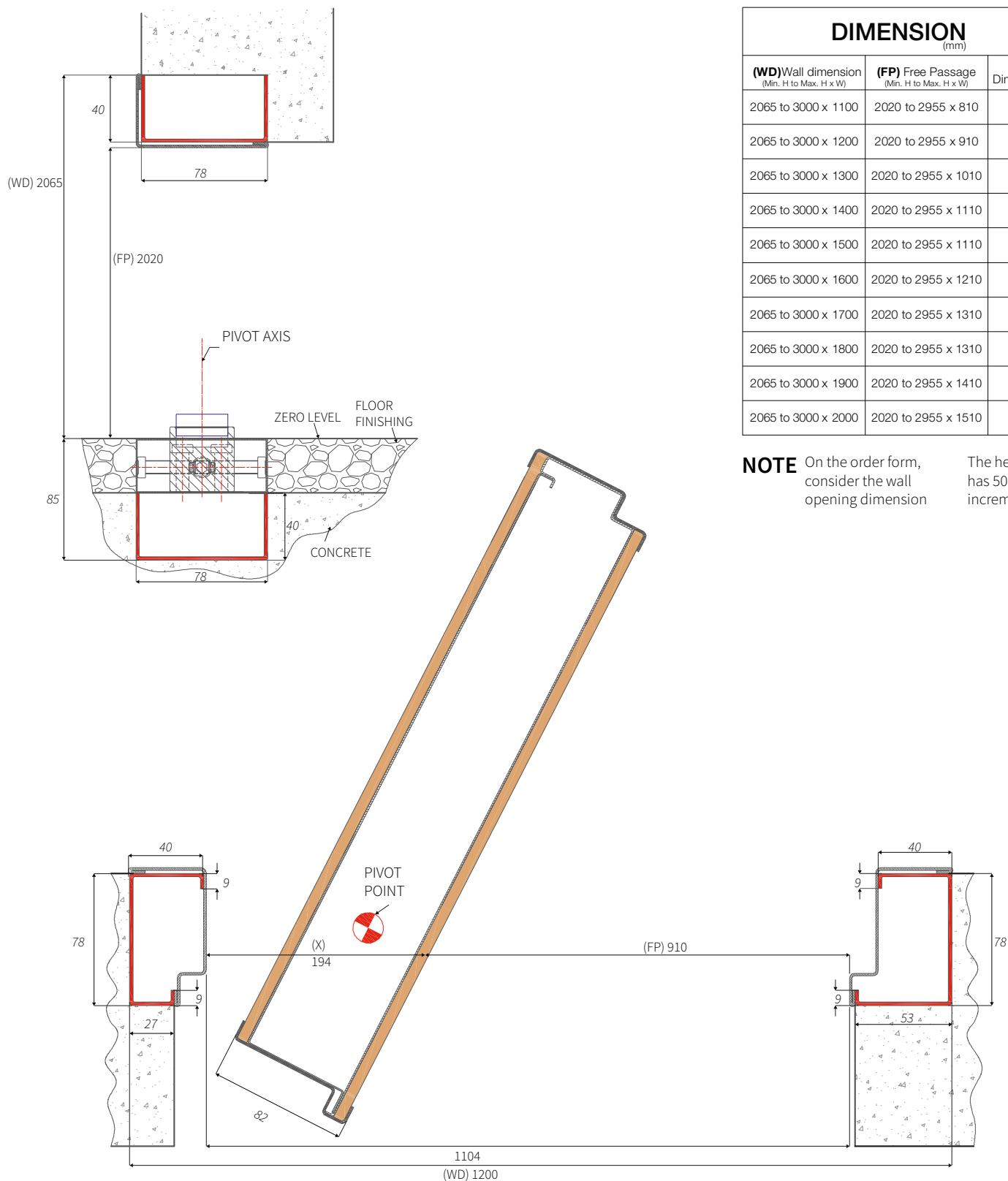



QUALITY MANAGEMENT SYSTEM certification  
 Certified. No. 0 001 08837  
 ISO 9001: 2015 - Awarded by the certifying entity TUV

Portrisa reserves the right to modify, at any time, without prior notice, the characteristics of the products presented in this catalog.

- All content is owned by Portrisa.
- All rights are reserved.

### BMTRADA

BURGLARY RESISTANCE Certificate according to EN 1627  
 Test report No. BMT / MTP / F14266 / B / 01/02/03  
 Level 3 - Assigned by the BMTRADA laboratory

### CNPP

A2P Certificate of RESISTANCE TO EFRACTION, according to the reference << H64 / T64-1 >>  
 Class BP1 - Certificate No. 26.81.64  
 Class BP2 - Certificate No. 2579.64-1  
 Assigned by the CNPP laboratory

### CSTB

FIRE FIGHTING certificate according to EN 13501-2 + A1: 2013  
 Test report No. RS13-052  
 Renewal No. 18/1  
 Fire resistance EI2 30 - Assigned by the CSTB laboratory

### CSTB

FIRE FIGHTING certificate according to NF EN 13501-2 + A1: 2016-07  
 Test report No. RS16-044  
 Fire resistance EI2 60 - Assigned by the CSTB laboratory

### AFITI LICOF

FIRE FIGHTING certificate according to UNE-EN 1634-1: 2000  
 Test report No. C1821T09  
 Fire resistance EI2 30 - Assigned by the AFITI LICOF laboratory

### CERIBOIS

THERMAL INSULATION certificate according to EN ISO 10077-1 and 10077-2  
 Test report No. 6.10.504.1  
 Thermal Insulation of  $U_d = 1.6W / m^2.K^*$   
 Assigned by the CERIBOIS laboratory

### BMTRADA

WEATHERTIGHTNESS certificate according to BS EN 1026: 2000, BS EN 1027: 2000, and BS EN 12211: 2000, respectively  
 Test report No. BMT / MTP / F14266 / 01 / A / Rev2  
 A: 300Pa (Class 2)  
 Water: 200Pa (Class 5A)  
 Wind: 1200 Pa (Class A3)  
 Assigned by the BMTRADA laboratory

### CERIBOIS

WEATHERTIGHTNESS certificate according to NF EN 14351-1 standards  
 Test report No. 1017  
 Air: A \* 3  
 Water: E \* 2B  
 Wind: V \* C3  
 Assigned by the CERIBOIS laboratory

### CERIBOIS

ACOUSTIC INSULATION according to NF EN ISO 140-1: 1997  
 Isolation of  $R_w / (C; C_{tr}) = 41 (-3; -8) dB$   
 Test report No. AC12  
 Assigned by the CERIBOIS laboratory

### ITB

ACOUSTIC INSULATION certificate according to EN 20140-3: 1999  
 Test report No. LA / 1667/08  
 $R_w (C; C_{tr}) = 44 (-4; -9) dB$  - Assigned by the ITB laboratory



# PORTRISA

SECURITY AND FIRE DOORS



Portrisa is one of the most important European companies important in the manufacture of doors. With its headquarters in Portugal it has a great productive capacity and built in Leiria its largest fully modernized production unit, with more than 26000m2 and a covered area of 10000m2, where it has the highest technology through systems

automated and robotic. Portrisa, strives for quality in its structure which is why it is certified under the Standard ISO 9001: 2015 and its products comply with the most demanding international standards. Portrisa exports to Europe, Asia, Africa and America, as a worldwide reference.

[www.portrisa.com](http://www.portrisa.com)

HEADQUARTERS | FACTORY  
Zona Industrial Ponte da Pedra  
Rua da Majoeira | Apartado 47  
2416-901 Leiria | PORTUGAL  
Telf.+ 351 244 720 610  
Fax + 351 244 720 619  
[portrisa@portrisa.pt](mailto:portrisa@portrisa.pt)

ALGARVE DELEGATION  
Rua da Escola, Arm. 1 e 2, EN125  
Patã de Cima  
8100-087 Boliqueime  
ALGARVE | PORTUGAL  
Telf. + 351 912 589 608  
[algarve@portrisa.com](mailto:algarve@portrisa.com)

LISBON DELEGATION  
Quinta de Santa Rosa  
Rua Particular N° 9  
2680-159 Camarate | PORTUGAL  
Telf. + 351 912 589 606  
[lisboa@portrisa.com](mailto:lisboa@portrisa.com)

NORTHERN DELEGATION  
Avenida Américo Duarte, 774  
S. Pedro de Fins  
4425-504 Maia | PORTUGAL  
Telef. + 351 918 666 150  
[norte@portrisa.com](mailto:norte@portrisa.com)

